



**SOS SOUNDS**  
TRUE WIRELESS EARBUDS



User Manual

### Select ear tips

Large Medium Small

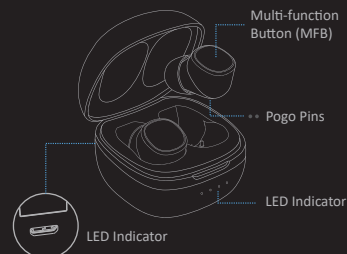

Charging Interface

The medium ear tips are the right fit for most people. We recommend trying this for the first time.

### How to Use

First use

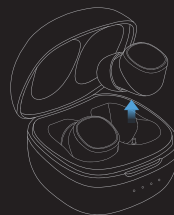

Take out both ear buds then re-insert them back into the case to activate the SOS Sounds true wireless earbuds. Notes: If Earbuds fails to charge, please charge the case via USB cable (for details, please refer to the following step)

### How to pair

1. Activating the Earbuds
2. Take out the Earbuds from the case, they will auto power on and pair with each other
3. Right Earbud will auto enter into pairing mode while LED light on right Earbud will be turn off.
4. Search for "SOS Sounds TWE" on your smart device and tap to pair it to both Earbuds.

### Resetting

Please try the following steps if the earbuds fails to connect with the mobile device



1. Take out the two earbuds, press the button for 3s, the LED lights turn off
2. Press the button for 10s. the LED will be flashing red and white at the same time, then the lights will turn off.
3. Put the two earbuds back into the charging case again, then take them out from the case, it will auto turn on and pair with each other.
4. Search for "SOS Sounds TWE" on your smart device and tap to pair it to both Earbuds

### Wearing



Put the Earbuds into ears lightly with mic towards to the front side

### Charging

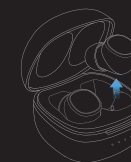

- a** Charging the Earbuds
- Insert the Earbuds into the charging case (pogo pins should be well-connected). LED light will be Red while charging and turns into White (this will last for 60s) once full charged.



USB Charging Port

- b** Charging the Case
- Note: There are 4 LED lights to show the charging case battery status. This signifies there is 25%,50%,75%,100% battery in sequence.

FC CE RoHS  
Made in China

### Functions

#### Power-On

Method 1: Take out the Earbuds from the charging case, It will auto power on.  
Method 2: Tap the multi-function buttons for 1s



#### Power-Off

Method 1: Put the EarBuds back into the charging case, It will auto power off.  
Method 2: Tap the multi-function buttons for 3s

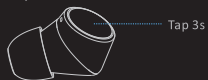

#### Answer/Hang up the call

Tap the multi-function button to answer the call, Tap the button again to hang up.

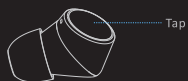

#### Decline a call

Tap the multi-function button for 1s.

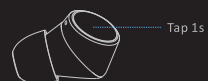

#### Switch Audio Output

Under the calling status, Tap the multi-function button for 1s to switch audio output between cellphone and Earbuds.

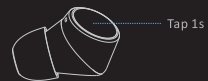

#### Mute-on/off

Under the calling status, Tap the multi-function button twice to turn on or off the Mute function.



#### Play/Pause the music

Tap the multi-function button to play/pause the music.



#### Skip to last song

Tap the left earbuds twice to play the last song.

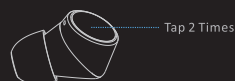

#### Skip to next song

Tap the right earbuds twice to play the next song.



#### Voice Assistant

Under the standby status, tap the multi-function button for 2s to activate the voice assist (e.g. Siri).



#### Volume -

Tap the left earbuds 3 times to decrease the volume.



#### Volume +

Tap the right earbuds 3 times to increase the volume.

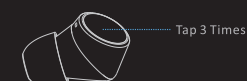

### Tips

1. Before using the SOS Sounds True Wireless Earbuds, please read the user manual carefully and keep safe for future references.
2. The SOS Sounds TWE should be fully charged before first-time use
3. If it is not being used for over 1 month please charge fully before using it again.
4. Please use the qualified adapter.
5. If the SOS Sounds TWE is not found on your smart device, please make sure it is in pairing mode; if the SOS Sounds TWE haven't been paired for a long time, it will exit pairing mode, please re-enter the pairing mode; if a procedure error occurs on smart device, please reset it; otherwise, reset the earbuds.

### Warning

1. Never disassemble or modify the SOS Sounds TWE to avoid causing any damages or dangers.
2. Do not store it in extreme temperatures (under 0 C or over 45 C)
3. Keep away from the small children.
4. Do not use during thunderstorms.
5. Do not use harsh chemicals or strong detergents to clean it.
6. Keep dry where possible.